

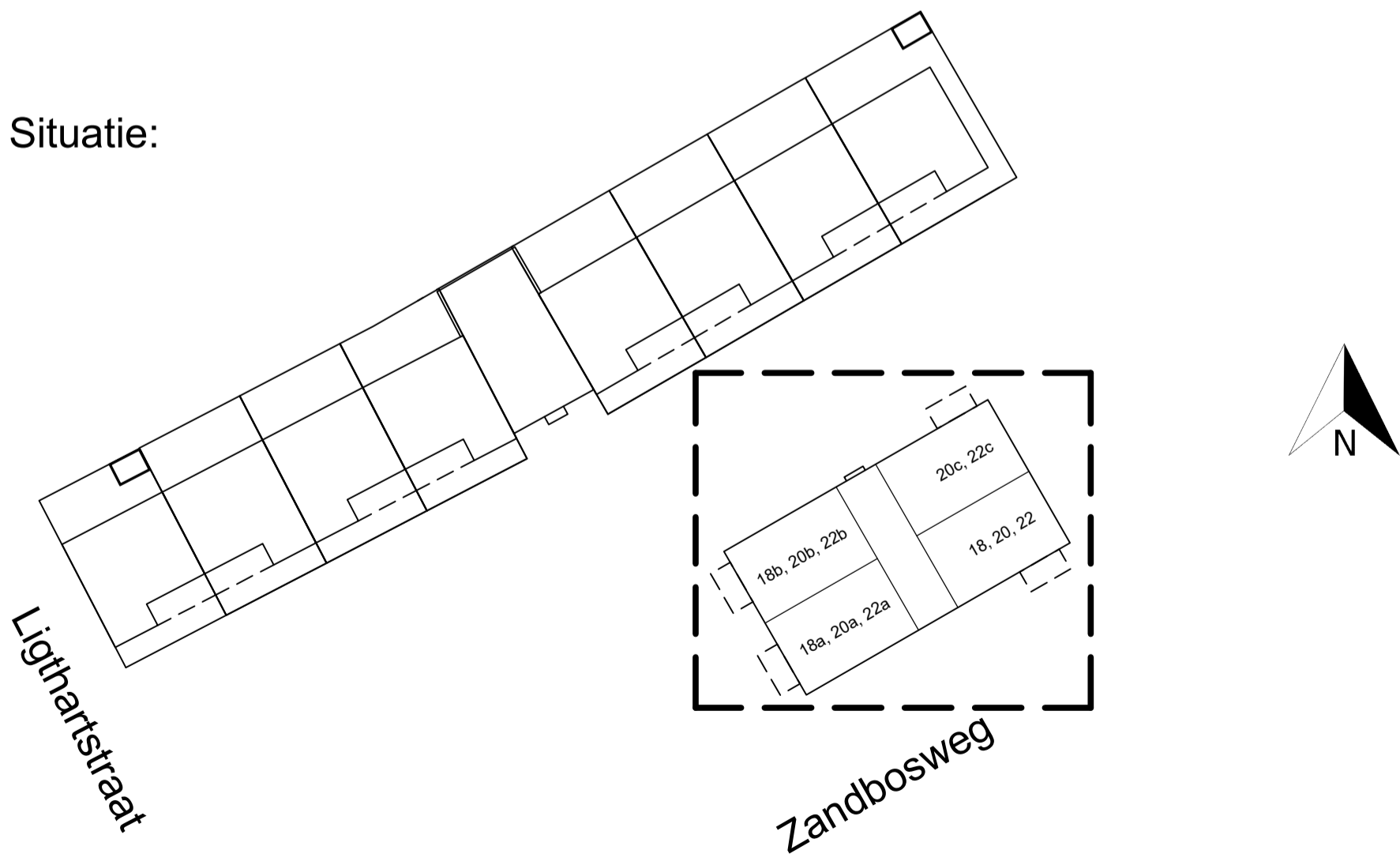











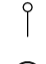

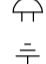







Situatie:

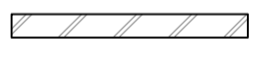

| Symbol  | Omschrijving                                     |
|---|--|
|    | Aansluitpunt 1 fase, nul en beschermingscontact  |
|    | Aansluitpunt data 1-voudig                       |
|    | Aansluitpunt data 2-voudig                       |
|    | Aansluitpunt niet bedraad (loze leiding)         |
|    | Wand lichtpunt                                   |
|    | Wand lichtpunt waterdicht                        |
|    | Bel  |
|   | Centraal aardpunt                                |
|  | Centraaldoos t.b.v. lichtpunt                    |
|  | Drukknop   |
|  | Zakleiding                                       |
|  | Stijpleiding                                     |
|  | Rookmelder                                       |
|  | Schakelaar, 1-polig                              |
|  | Thermostaatleiding, bedraad                      |
|  | Wandcontactdoos 1-voudig met beschermingscontact |
|  | Wandcontactdoos 2-voudig met beschermingscontact |
|  | Ventilatiepunt                                   |

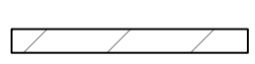
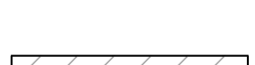
|  |                               |
|--|-------------------------------|
|  | Gevelsteen keimwerk:          |
|  | Gevelsteen 20mm teruglg.:     |
|  | Gasbeton:                     |
|  | Kalkzandsteen:                |
|  | Kalkzandsteen velling schoon: |
|  | Isolatie:                     |

## Begane Grond

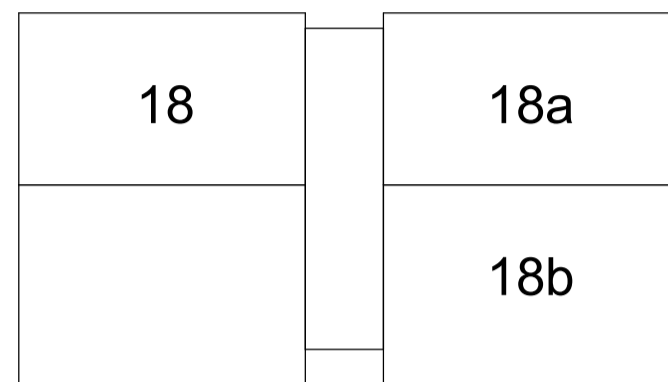

## 1e Verdieping

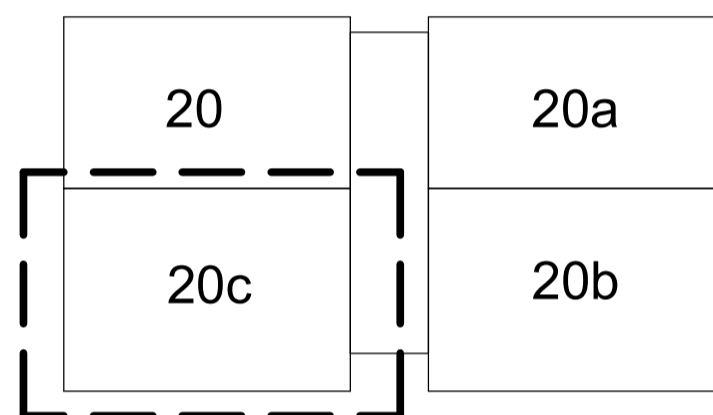

## 2e Verdieping

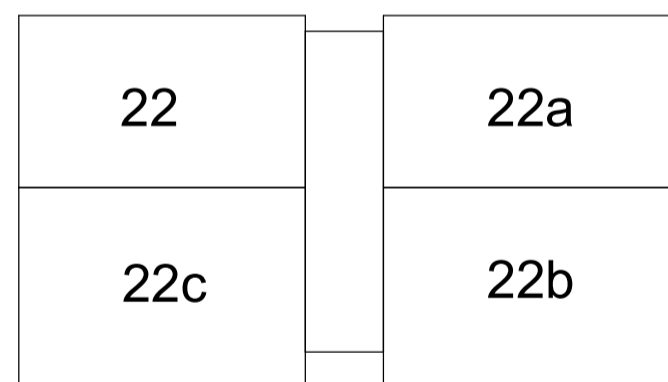

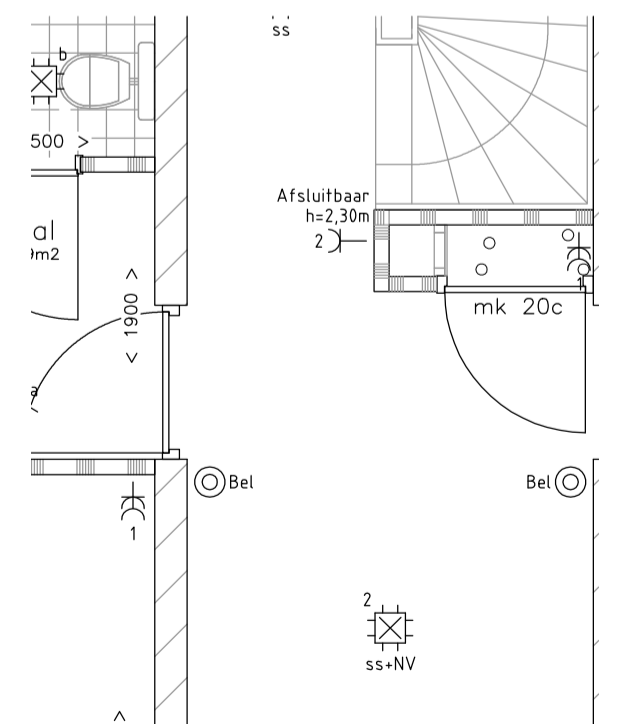
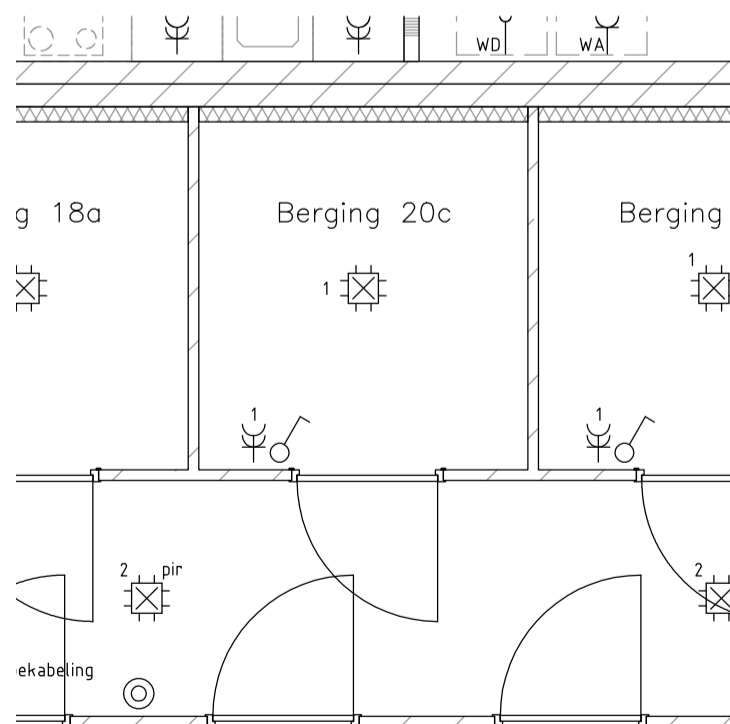
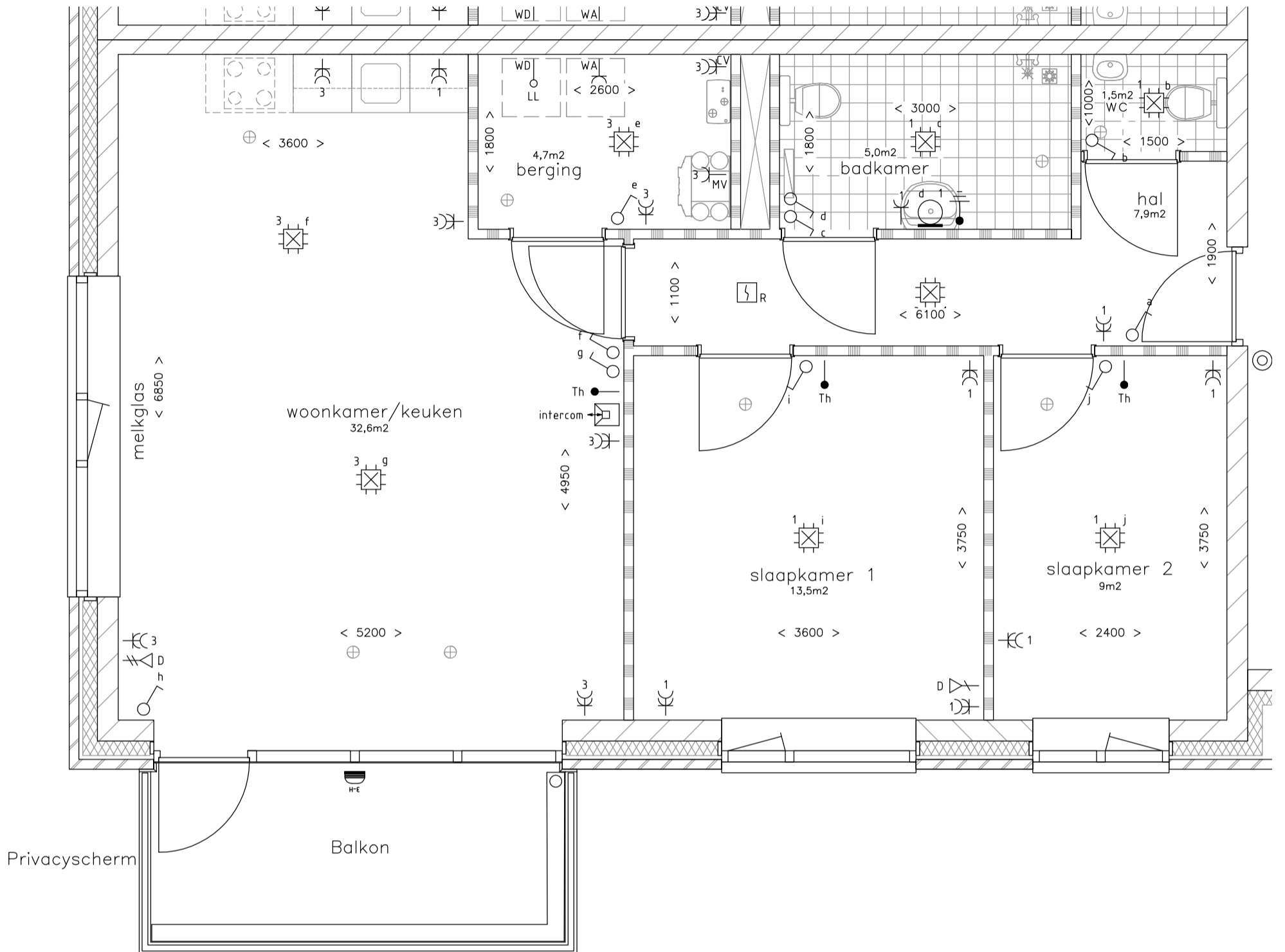

MK bij voordeur