

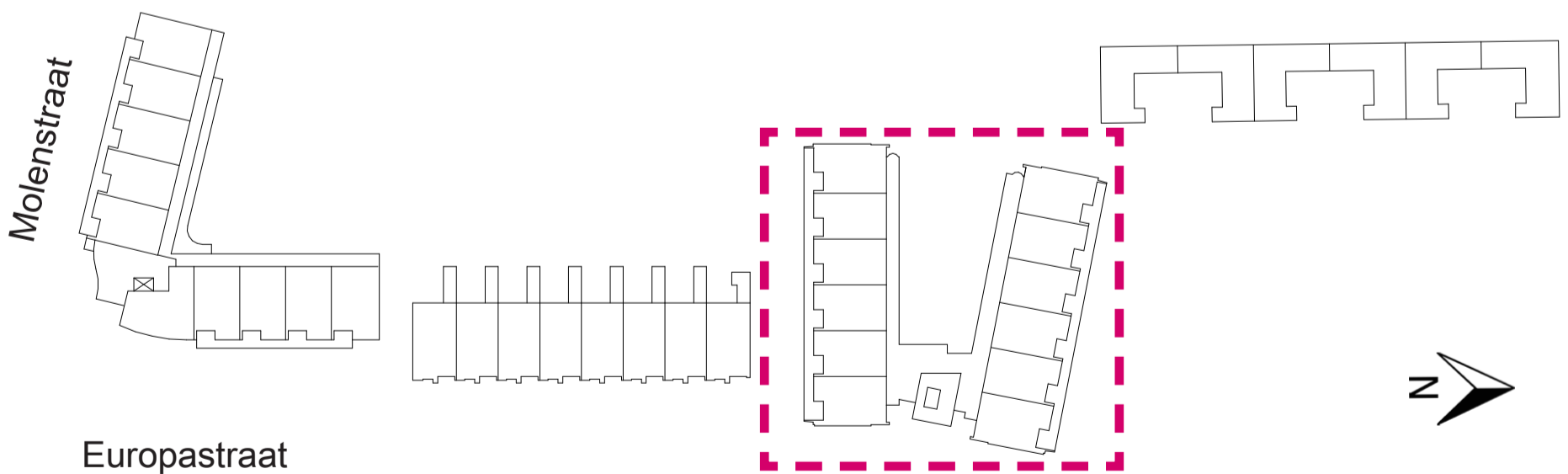

SITUATIE:



DATUM:

15-12-2017

LAATSTE WIJZIGING:

nvt





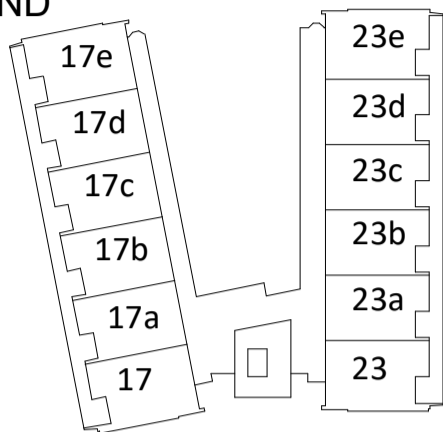

BLAD:

VK-25.1

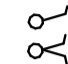
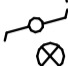
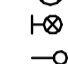
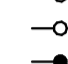
BEGANE GROND

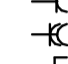
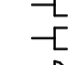
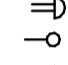
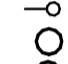

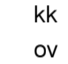
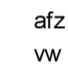
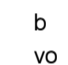
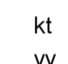
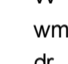
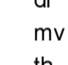
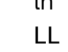
Renvooi:

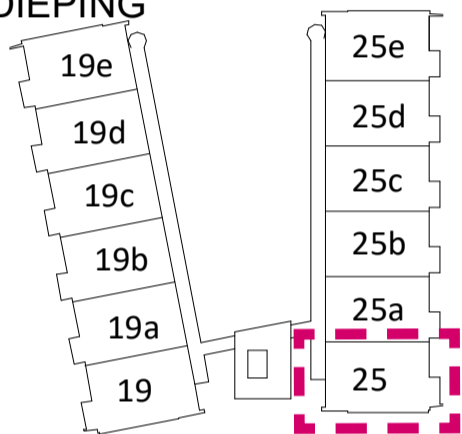

- | | |
|-------------------------------------------------------------------------------------|---------------------------------------------|
|  | Enkele schakelaar |
|  | Serie schakelaar |
|  | Wissel schakelaar |
|  | Plafond lichtpunt |
|  | Wand lichtpunt |
|  | Loze leiding met blindplaat |
|  | Loze leiding tbv cai met blindplaat |
|  | Bedrade leiding tbv telefoon met blindplaat |
|  | Bedrade leiding tbv cai met blindplaat |
|  | Enkele wandcontactdoos |
|  | Vert. dubbele wandcontactdoos |
|  | Thermostaat |
|  | Naregeling thermostaat |
|  | Schel |
|  | Deurbel |
|  | Co2 melder |
|  | Afzuigpunt mechanische ventilatie |
|  | Rookmelder |
-
- | | |
|-----|--------------------------|
| kk | = Koelkast |
| ov | = Oven |
| afz | = Afzuigkap |
| vw | = vaatwasser |
| b | = Boiler |
| vo | = Vonk |
| kt | = Kooktoestel |
| vv | = Vloerverwarming |
| wm | = Wasmachine |
| dr | = Droger |
| mv | = Mechanische ventilatie |
| th | = Thermostaat |
| LL | = Loze leiding |

1E VERDIEPING

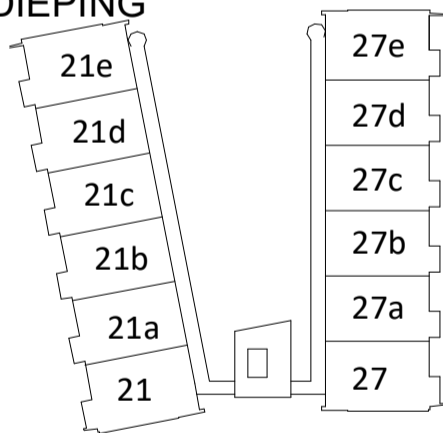

2E VERDIEPING



- | | |
|--------------------------------------------------------------------------------------|------------------------------------|
|  | Metselwerk |
|  | Kalkzandsteen |
|  | Houtskeletbouw wand |
|  | Steenachtige lichte scheidingswand |

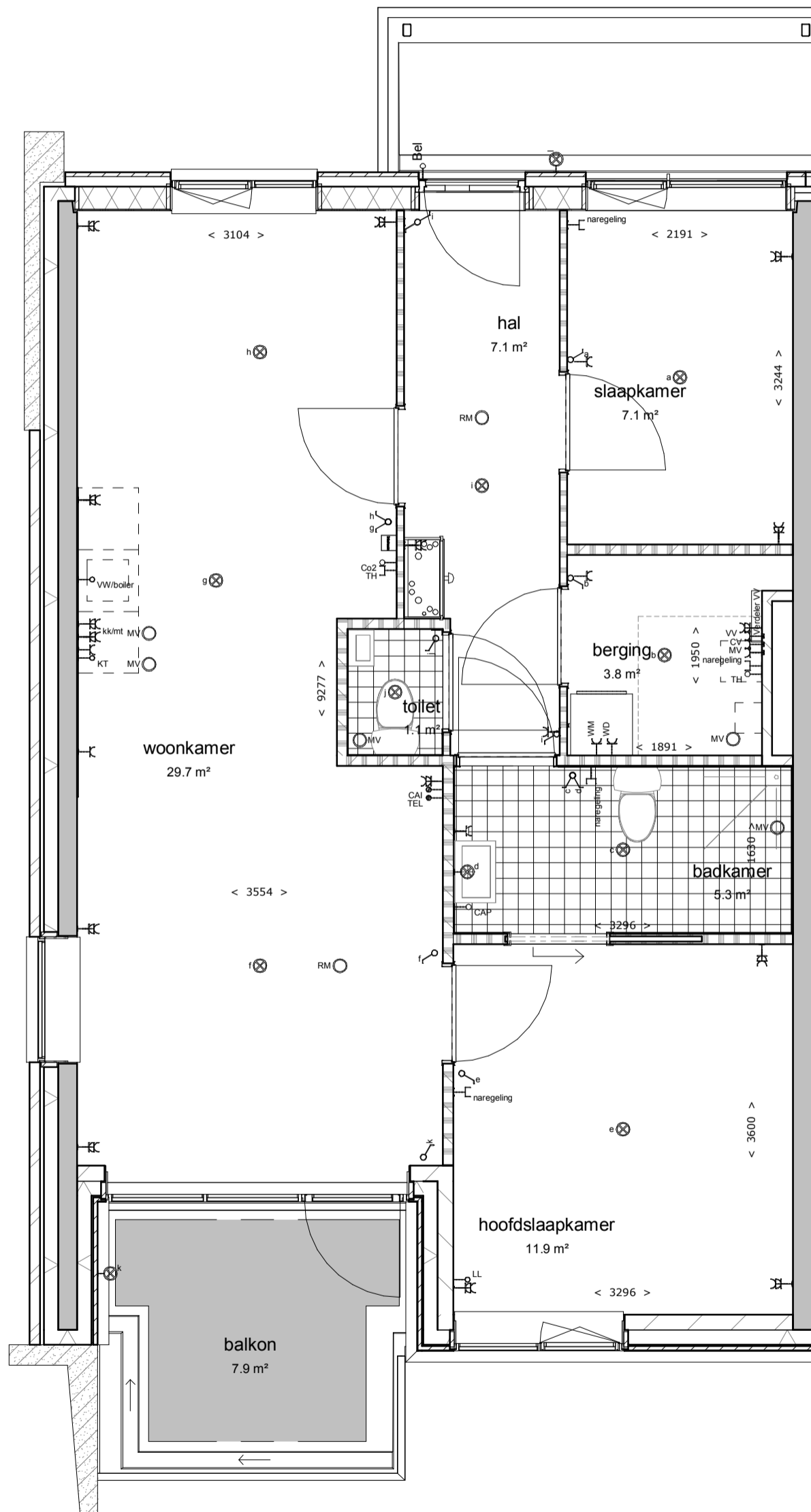

OMSCHRIJVING:

Schaal:

BLAD:

Plattegrond

1:50

VK-25.3



Alle bergingen zijn voorzien van:
 - dubbele wandcontactdoos
 - lichtpunt met schakelaar

OMSCHRIJVING:

Schaal:

BLAD:

Kelder

1:100

VK-25.4